

WR □ 系列

耐磨切断热电偶

Wear-resisting Cutting Thermocouple

应用 Application

通过在耐磨头喷涂Ni+Wc35, 使钢的硬度提高, 适用于生产现场存在高耐磨固体颗粒或流体, 当保护管发生损坏时可切断电偶, 是炼油厂不可缺少的测温装置。

Improving the hardness of steel through painting and welding Ni+Wc35 on the wear-resisting head. It is used for the occasions that there is highlywearable solid or liquid, when there is destroy for thermowell, thermocouple can cut off the power, it is a necessary device for refineries.

主要技术参数 Main Technical Parameters

- 电气出口: M20×1.5, NPT1/2
- Electric Outlet: M20×1.5, NPT1/2
- 耐磨头硬度: HRC 62~65
- Wear-resisting Head Hardness, HRC~65
- 防护等级: IP65
- Protection Class: IP65
- 隔爆等级: d IIBT4, d IIC T5
- Explosion Separation Class
- 公称压力: 2.5MPa

型号及规格 Type & Specification

型号 Type	分度号 Graduation	测温范围℃ T. range	保护管材料 Thermowell Material	热响应时间 TRT	规格 LxI Specification
QMWR R-430 QMWR R _y -430	S	0~1300	GH2140	<180s	450×300 500×350 550×400 600×450 650×500 750×600
QMWR N-430 QMWR N _y -430	K	0~1000 0~800	GH3030 1Cr18Ni9Ti		
QMWR E-430 QMWR E _y -430	E	0~600	1Cr18Ni9Ti		
QMWR R-440 QMWR R _y -440	S	0~1300	GH2140		
QMWR N-440 QMWR N _y -440	K	0~1000 0~800	GH3030 1Cr18Ni9Ti		
QMWR E-440 QMWR E _y -440	E	0~600	1Cr18Ni9Ti		

★: 1) 热电偶 I 级按协议订货;

Class I thermocouple shall be ordered according to agreement

2) 型号430为防水式, 型号440为隔爆式

Type 430 is waterproof, 440 is explosion separation.

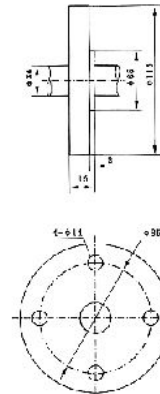
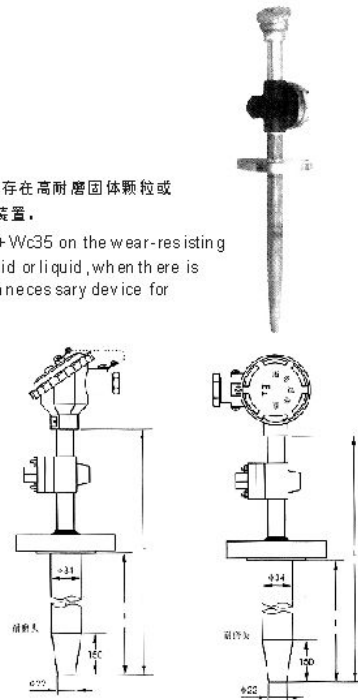



欢迎免费索取关于耐磨切断热电偶选型手册 请联系北京昊海云天客服 010-52882318
北京昊海云天科技发展有限公司电子版资料下载 <http://www.hhytyb.com/download/>